

A change in camber also means a change in toe; this means that camber must be adjusted first.

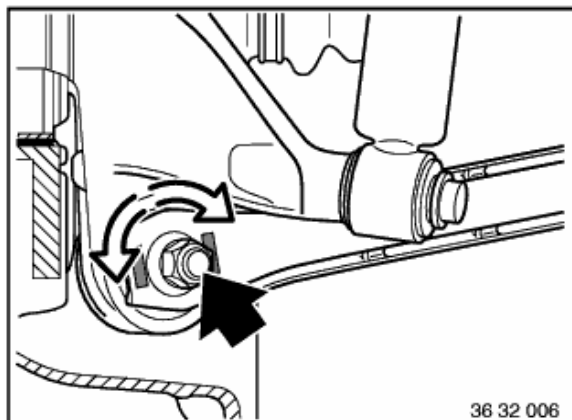

Adjusting camber:

Replace and tighten down hexagon collar nut. The eccentric washer must be located between the support cams. Tightening Torque,

refer to Technical Data 33 32 11AZ.

Slacken hexagon collar nut approx. 1/2 turn. Turn eccentric screw

and adjust camber to specified value,

refer to Technical Data.

Installation:

Tightening Torque,

refer to Technical Data 33 32 11AZ.

Caution!

If the hexagon collar nut is tightened down more than 10 times during adjustment, it must be replaced again. The self-locking effect becomes too slight.

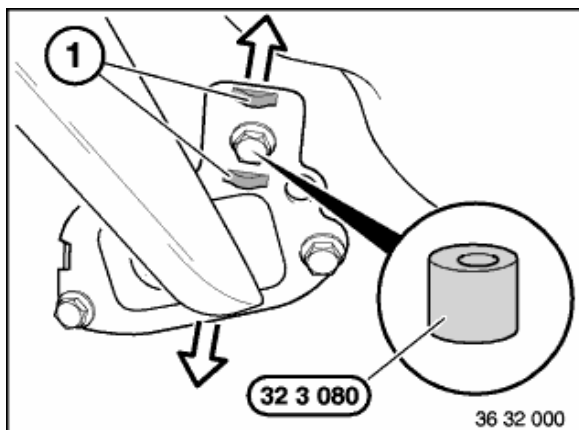

Adjusting toe-in:

Release bolts approx. 1 1/2 turns on bearing support. Apply special tool 32 3 080 on bolt head between stops (1). Rotate special tool and adjust toe-in of left/right wheel to specified value, refer to Technical Data.

Installation:

Tightening Torque,

refer to Technical Data 33 32 13AZ.

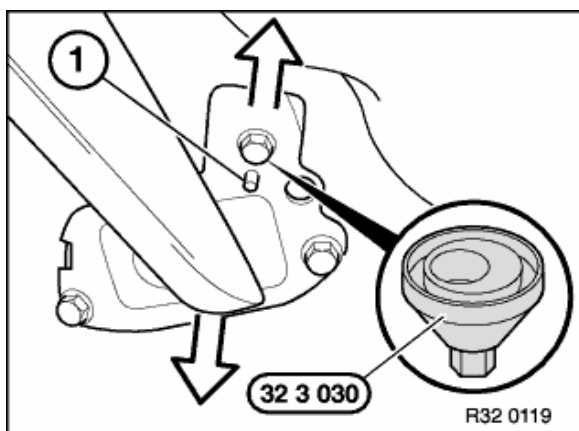

Bearing support with pin or notch:

Attach special tool 32 3 030 to bolt head and pin/notch (1). Work step, see above.